

# DREXEL UNIVERSITY EXCHANGE STUDENT FACT SHEET 2015-2016

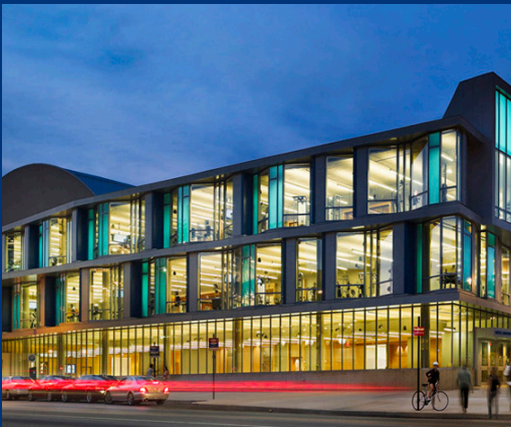

## WHY PHILADELPHIA?

Philadelphia, the birthplace of the United States and its fifth largest city, is home to more than 5 million people. Situated halfway between New York City and Washington, D.C., it's the perfect place to study in the United States. Drexel is located in the heart of University City, a thriving student and scholar community, just minutes from Center City, Philadelphia. Visitors will find colonial-era monuments in a modern metropolis rich with history and innovation. Navigable by bus, subway, bicycle, or foot, Philadelphia offers endless opportunities to explore diverse communities, countless museums, exciting sports, live arts, and world class culture.

## WHY DREXEL?

Drexel University is a private research institution ranked among the top 100 universities in the United States. With 15 colleges and schools and more than 200 degree programs, Drexel offers incoming exchange students an opportunity for a truly comprehensive academic experience.

## WHO QUALIFIES?

Students who meet the follow qualifications:

- Minimum GPA 3.0
- English Language Proficiency tests\*:

TOEFL iBT	80
IELTS	6.5
TOEFL CBT	214
TOEFL PBT	550
- Application materials submitted by deadline

## WHAT'S THE PROCESS?

1. Apply to Drexel's exchange program via your home school's international office.
2. Receive an email from Drexel with login instructions for the online applications.
3. Complete the online application before the deadline.
4. We welcome you to Drexel!

\*Drexel does not accept TOEFL ITP



# COLLEGES AND PROGRAMS

## College of Arts and Sciences

Anthropology  
 Biodiversity, Earth & Environmental Science  
 Biology  
 Chemistry  
 Communication  
 Criminal Justice  
 English  
 Geoscience  
 History & Politics  
 International Area Studies  
 Mathematics  
 Philosophy  
 Physics  
 Sociology

## College of Nursing and Health Professions\*

Behavioral Health  
 Counseling  
 Health Services Administration  
 Health Sciences  
 Nutrition & Foods  
 Radiologic Technology  
 Invasive Cardiovascular Technology  
 Nursing

## LeBow College of Business

Accounting  
 Business Analytics  
 Decision Sciences  
 School of Economics  
 Finance  
 General Business  
 International Business  
 Legal Studies  
 Management  
 Management Information Systems  
 Marketing

## College of Computing and Informatics

Computer Science  
 Informatics  
 Information Technology  
 Information Systems  
 Computing and Security Technology

## School of Education\*

Elementary Education  
 Secondary Education

## Westphal College of Media Arts & Design\*\*

Animation and Visual Effects  
 Architecture\*  
 Dance  
 Design & Merchandising  
 Entertainment & Arts Management  
 Fashion Design  
 Film & Video  
 Game Art & Production  
 Graphic Design  
 Interior Design  
 Interactive Digital Media  
 Music Industry  
 Photography  
 Product Design  
 Screenwriting & Playwriting  
 TV Production & Media Management  
 Westphal Studies

## School of Biomedical Engineering, Science, & Health Systems

Biomedical Engineering

## College of Engineering

Architectural Engineering  
 Chemical Engineering  
 Civil Engineering  
 Computer Engineering  
 Construction Management  
 Electrical Engineering  
 Engineering Technology  
 Environmental Engineering  
 Materials Science & Engineering  
 Mechanical Engineering

## Center for Hospitality and Sport Management

Culinary Arts  
 Food Science  
 Hospitality  
 Tourism Management  
 Sport Management

## Kline School of Law\*

## School of Medicine\*

## School of Public Health\*

\*Schools or programs may be closed to exchange students

\*\*Students may have to submit a portfolio to be considered

**DREXEL'S NUMBERS:**

**16,986**  
undergrad students

**9,436**  
grad students

**WE COME FROM:** 48 states  
102 countries

# PRACTICAL INFORMATION

## COURSES

- Undergraduate exchange students must take 12-20 course credits per quarter
- Students will be required to take at least 50% of their courses each term from within their assigned Drexel major
- Each student will be assigned to a Drexel academic advisor who will register them for classes
- Class selection is subject to course availability and fulfillment of pre-requisites



## HOUSING

- On-campus housing is guaranteed for full-year (fall/winter/spring) students, but cannot be guaranteed for 1-2 term students
- Suite style and double-occupancy rooms are available
- Off-campus housing is also available. Students must arrange off-campus accommodations independently



## MEALS

- Exchange students may participate in university dining plans, but they are not required to do so
- Students living in on-campus residence halls will have shared access to kitchen facilities
- There are a variety of restaurants and grocery stores near the university

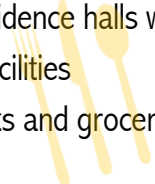

## VISA

- All incoming exchange students are required to obtain a J1 Student Visa
- Drexel will issue a DS-2019 visa document to students upon acceptance



## HEALTH INSURANCE & IMMUNIZATIONS

All exchange students must...

- Purchase Drexel's health insurance in order to meet US immigration health insurance requirement
- Pay a \$35 immunization fee
- Complete required immunizations

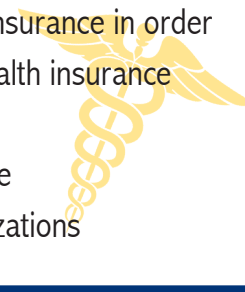

## ESTIMATED BUDGET

Housing	\$2,000-\$3,000/quarter
Meals	\$1,000 - \$1,895/quarter
Books	\$500/quarter
Health Insurance	\$600 - \$900/quarter
Immunizations	\$35 (one-time fee)
Personal Expenses	varies
SEVIS & Visa Fees	\$450 (one-time fee)

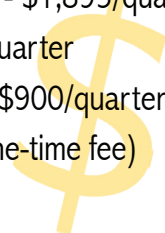

**MORE INFO AT [DREXEL.EDU/STUDYABROAD/EXCHANGE](https://drexel.edu/studyabroad/exchange)**

## NOMINATION DETAILS

All exchange students must be nominated by their home institution to participate in the exchange program. If you have not yet been nominated, please contact your home school advisor.

Students will be nominated to the major at Drexel that most closely matches their home school major (see page 2 for a list of all majors). Once matched and accepted, the student will take 50% of classes from within that major.

## DEADLINES

	Nomination Deadline (from home school)	Application Deadline (materials received from student)
Fall term (Sept-Dec)	April 1	April 15
Winter term (Jan-March)	September 15	October 1
Spring term (March-June)	November 1	November 15

## REQUIRED MATERIALS

Once you have been nominated, you will receive instructions via email about completing the online application. The following application materials will be required:

- J-1 Student form
- Official Transcript (in English)
- Financial support documentation (in English)
- Passport copy
- Inbound Exchange Application Form
- Official TOEFL/IELTS scores (if applicable)
- Preliminary course selections (at least 50% in your Drexel major)
- Portfolio (if applicable)

All materials may be submitted online (when applicable), via email to [studyabroad@drexel.edu](mailto:studyabroad@drexel.edu), or by mail by the above deadlines.

## CONTACT US

For more information about exchange programs, contact:

**[studyabroad@drexel.edu](mailto:studyabroad@drexel.edu)**

**+1-215-571-3558**

Office Address:

Paul Peck Problem Solving  
& Research Center  
101 N. 33rd St., Suite 201  
Philadelphia, PA 19104

Other contacts:

**Daniela Ascarelli**  
Director, Study Abroad  
[ascareld@drexel.edu](mailto:ascareld@drexel.edu)  
+1-215-895-6280

**Marcia Henisz**

Graduate Exchanges  
[mwh23@drexel.edu](mailto:mwh23@drexel.edu)  
+1-215-571-6372

